



Read all instructions BEFORE
assembly and USE of product.
KEEP INSTRUCTIONS FOR
FUTURE USE.



KeyFit® Caddy

Owner's Manual

WARNING

Failure to follow all warnings and instructions may result in serious injury or death. For your child's safety, read the labels and owner's manual before using the product.

- PLEASE SAVE OWNER'S MANUAL FOR FUTURE USE.
- ADULT ASSEMBLY REQUIRED.
- NEVER LEAVE CHILD UNATTENDED. Always keep child in view while in the caddy.
- AVOID SERIOUS INJURY from falling or sliding out. Always use the infant car seat harness and make sure that it is properly adjusted to provide a secure fit around your child.
- AVOID FINGER ENTRAPMENT: Use care when folding and unfolding the caddy. Be certain the caddy is fully opened and latched before allowing your child near the caddy.
- CADDY TO BE USED only at walking speed. Product not intended for use while jogging, skating, etc.
- TO PREVENT TIPPING, do not place more than 2 lbs (0.9 kg) on the parent's tray.
- TO AVOID BURNS, never put hot liquids in the parent's tray.
- TO PREVENT A HAZARDOUS, UNSTABLE CONDITION, never place purses, shopping bags, parcels or accessory items on the parent tray or handle. Do not place more than 10 lbs (4.5 kg) in the storage basket.
- DO NOT use storage basket as a child carrier.
- NEVER ALLOW YOUR CADDY to be used as a toy.
- DISCONTINUE USING YOUR CADDY should it become damaged or broken.
- AVOID STRANGULATION. DO NOT place items with a string around your child's neck, suspend strings from this product, or attach strings to toys.
- NEVER USE CADDY ON STAIRS or escalators. You may suddenly lose control of the product and your child may fall out. Also, use extra care when going up or down a step or curb.
- Do not attempt to attach any infant car seat to the stroller other than a Chicco infant car seat. Injury or death may result when attempting to use this stroller in conjunction with infant car seats from other manufacturers.
- Before use, remove and dispose of all plastic bags and packaging materials and keep them out of reach of children.
- Before assembly, check that the product and all of its components have not been damaged during transportation.
- Do not use accessories, spare parts, or any component not supplied or approved by Chicco as they may make the stroller unsafe.

WARNING

Failure to follow all warnings and instructions may result in serious injury or death. For your child's safety, read the labels and owner's manual before using the product.

Using Chicco Infant Car Seat with stroller:

- ONLY USE this product with a Chicco infant car seat. Do not use any other manufacturer's infant car seat.
- Only use this product to transport infants that are within the size and weight limitations of the infant car seat.
- FALL HAZARD: Always check that infant car seat is securely attached to stroller frame by pulling up on the infant car seat.
- ALWAYS SECURE your child with the car seat harness. Always make sure child is properly harnessed in the car seat.
- Refer to your Chicco infant car seat owner's manual for additional warnings and use instructions before using this product.

Parts List

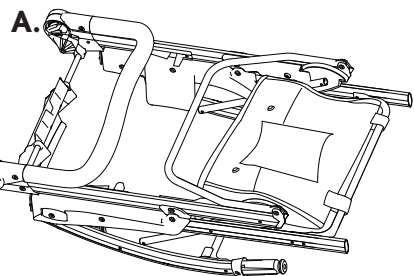

A. - Caddy Frame



B. - Front Swivel Wheels

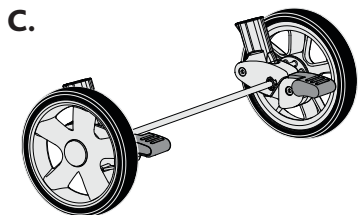

C. - Rear Axle Assembly

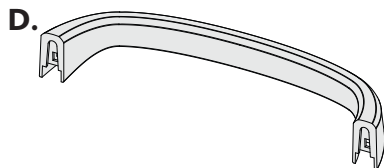

D. - Bumper Bar

Parts List

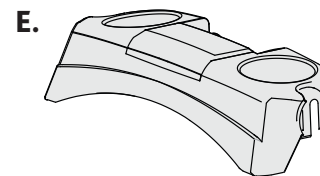

E. - Parent Tray

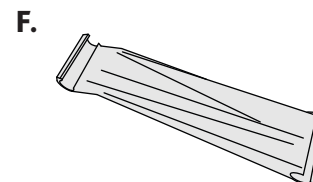

F. - Basket Brace

How To Attach Basket Brace

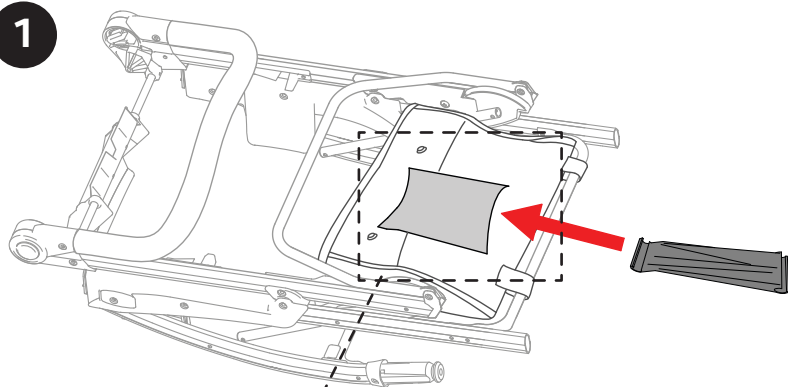

1. Insert Basket Brace (F) through Basket Brace sleeve and snap securely onto rear frame tube.

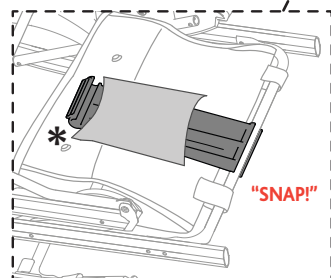

* Note: Basket Brace flat end is to the top.

Attach Rear Wheels

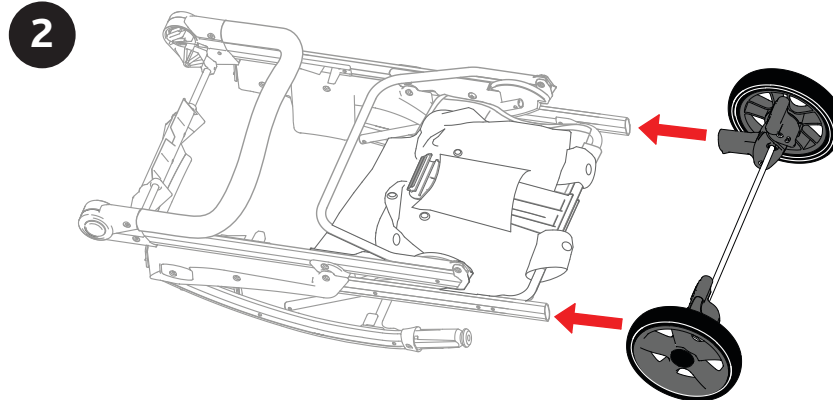

2. Attach Rear Axle Assembly (C) to the Caddy Frame as shown. The assembly will click into place. Pull on each Wheel to make sure the axle assembly is securely attached to the frame.

How to Attach Basket Brace

3A

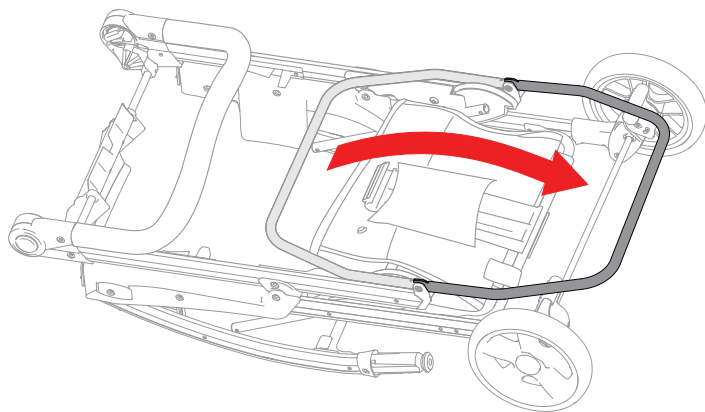

3A. Locate the Storage Basket frame (painted metal bar) on the Caddy Frame (A) and flip it open as shown.

How to Attach Basket Brace

3B

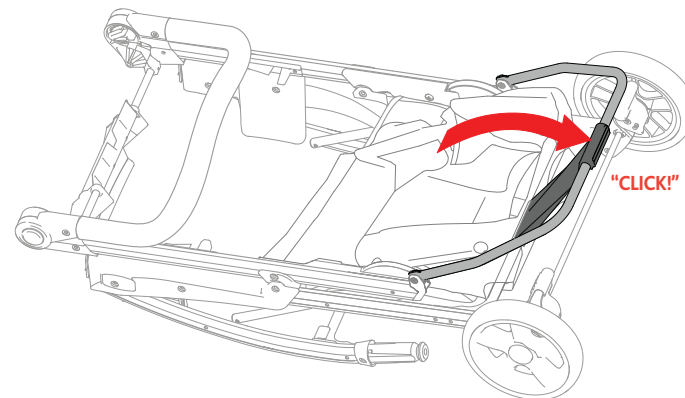

3B. Locate the Storage Basket Brace. Flip the Brace over and snap it into position, attaching it onto the Basket frame.

How to Open Caddy

3c

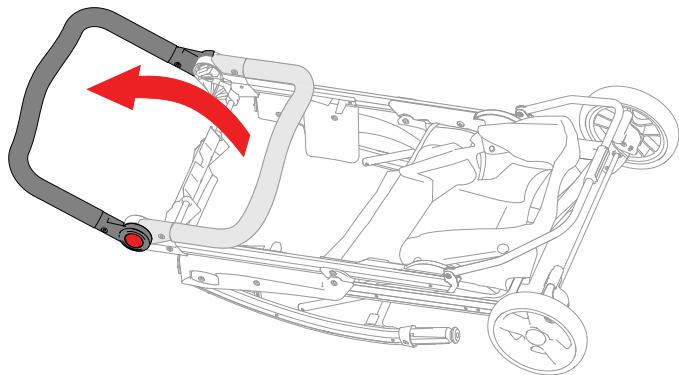

3C. Locate the Caddy Handle. Pull up on the Caddy Handle to lock it into the first position.

How to Open Caddy

4

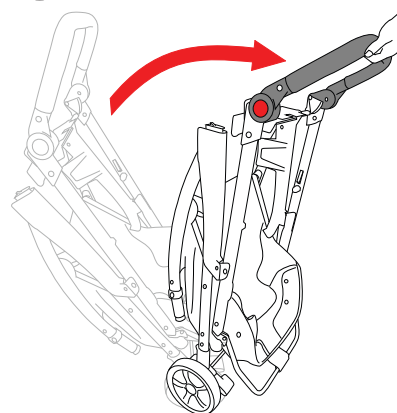

4. Using the Caddy Handle, stand the Caddy up so that it is resting on the Caddy Basket frame.

How to Open Caddy

5A

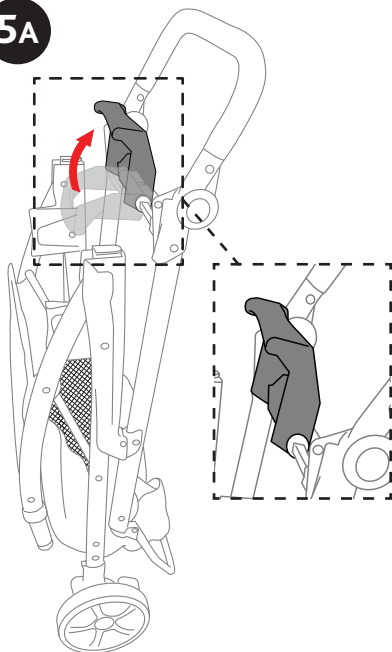

5A. With the Caddy in an upright position, rotate the Release Handle towards the Caddy Handle. Push on the Release Handle (5B) until you hear an audible click.

Note: It is necessary for this Release Handle to be locked into this position for the Caddy to open and close properly - Once this handle is locked into this position it is not intended to be unlocked.

5B

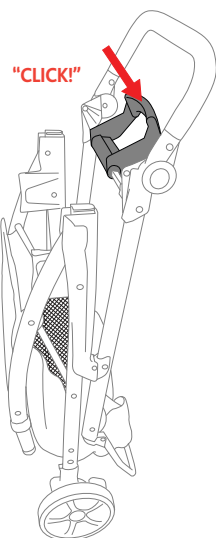

Assemble Parent Tray

⚠ WARNING

To prevent tipping, do not place more than 2 lbs (0.9 kg) in the parent's tray. Never put hot liquids in the cup holders. Never place purses, shopping bags, parcels or accessory items on the handle.

6

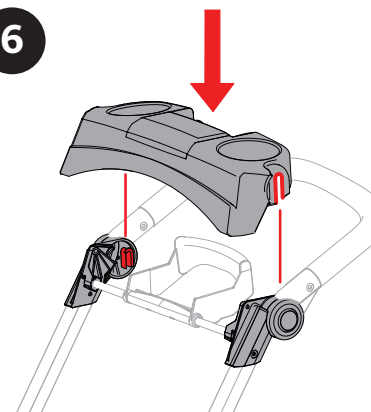

6. Locate the tabs on both ends of the Parent Tray (E) and slide the tabs through the channels on the inside of the Caddy handle. The tabs and grooves must be lined up. Then slide the Parent Tray into place. You will hear an audible click on both sides when the Parent Tray is secured to the Caddy handles. Pull up on each side of the Parent Tray to make sure the tray is securely attached.

"CLICK!"

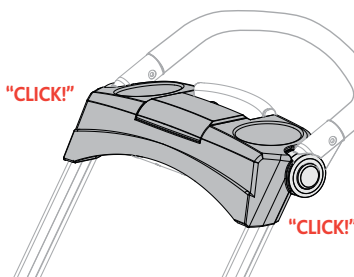

How to Open Caddy

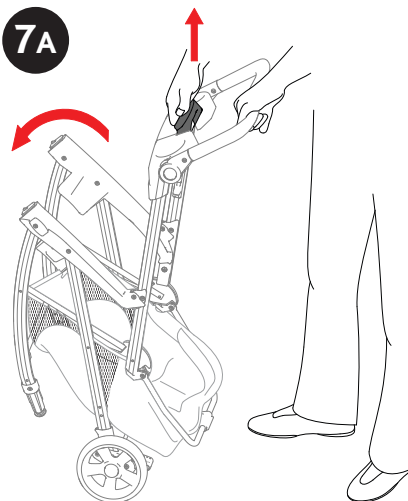

7A. Stand behind the Caddy. Place one hand on the Caddy Handle and one hand on the Release Handle. Lean the Caddy forward and pull up on the Release Handle to open the Caddy. You will hear an audible click on both sides when Caddy is completely open and locked (7B).

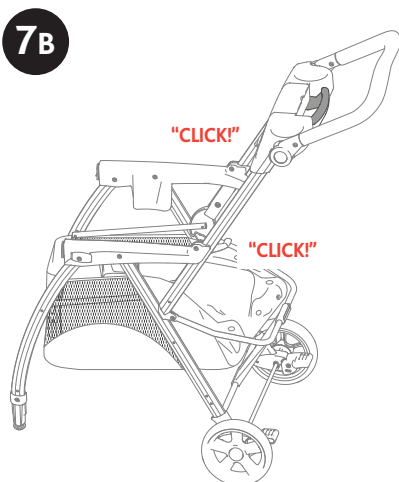

Attach Bumper Bar

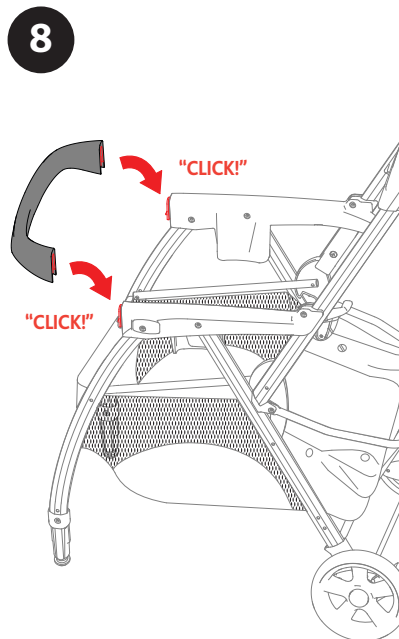

8. Attach Bumper Bar (D) to the frame as shown. You will hear an audible click when Bumper Bar is in place. Gently lift up on both sides of Bumper Bar to make sure it is secure.

Note: Once the Bumper Bar is installed it is not intended to be removed.

Attach Front Swivel Wheels

9

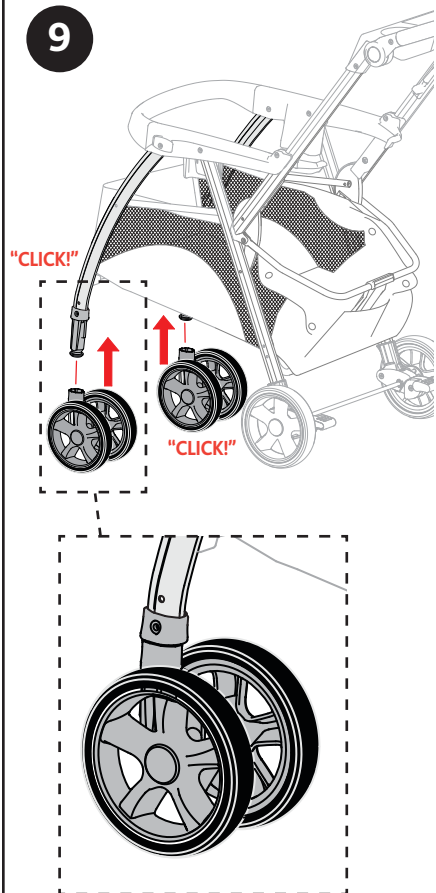

9. Attach Front Swivel Wheels (B) to the Caddy frame as shown. The Wheels will click into place. Pull down on each Wheel to make sure the Wheel assembly is securely attached to the frame.

Assemble Storage Basket

10A

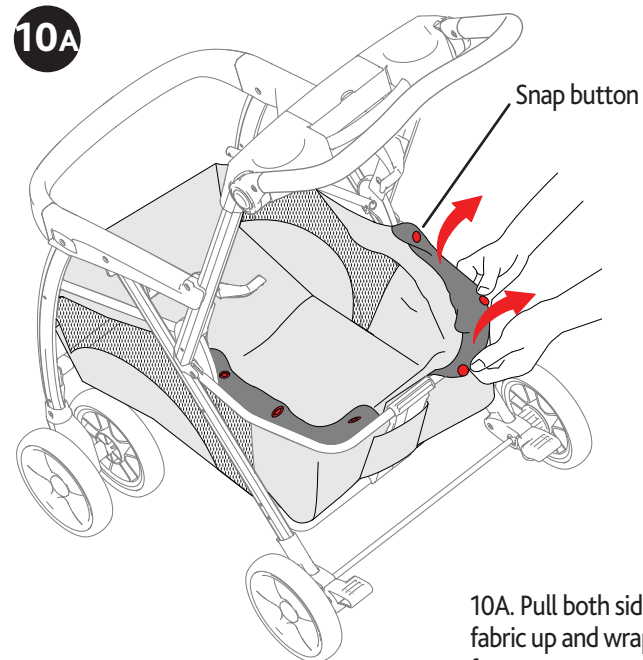

10A. Pull both sides of Storage Basket fabric up and wrap it around the Basket frame.

Assemble Storage Basket

10B

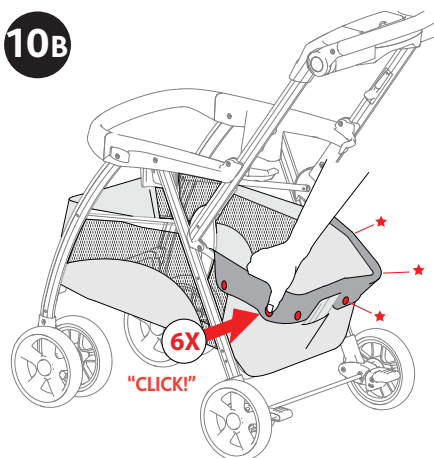

10B. Snap the 6 buttons into place as shown.

Storage Basket Access

11

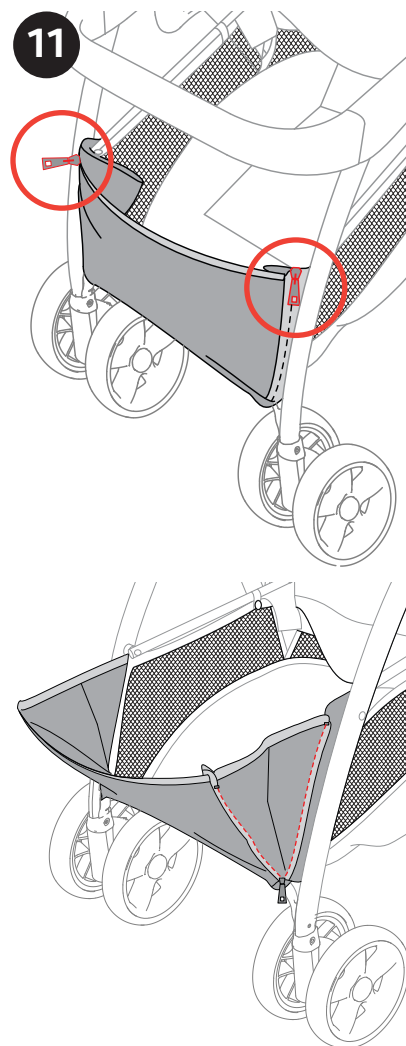

11. To access the Storage Basket from the front, unzip both zippers located on each side of the front of the Basket.

Storage Basket Access

12

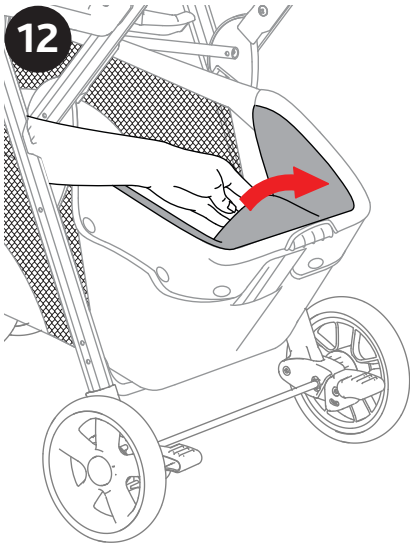

12. Extend the storage capacity of the Basket from the rear. Locate the edge of the extension flap, which is tucked inside the rear Basket edge. Flip the extension flap up.



Adjust Caddy Handle

13

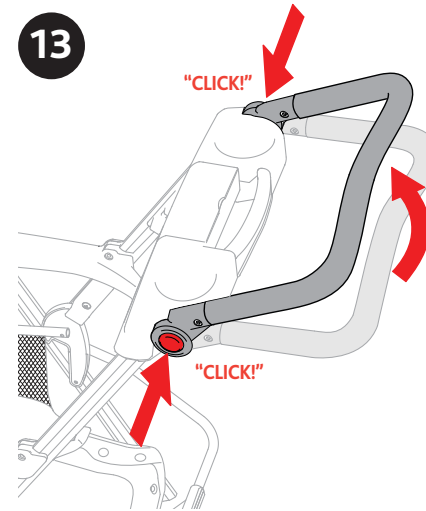

13. The Caddy Handle height can be adjusted for comfort. To adjust the Caddy Handle position, push in on both buttons (as shown) and rotate the Caddy Handle up or down. Make sure the Caddy Handle is securely latched before using.

How to Use Brakes

⚠️WARNING

Always apply both brakes whenever the caddy is stationary. Never leave the caddy on a sloped surface, with a child on board, even with the brakes applied.

14A

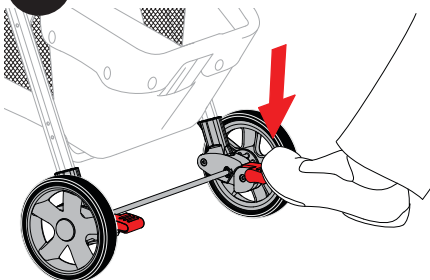

14. To lock the rear wheel brakes, push down on the brake lock levers located on each side of the rear wheel assembly (14A). To unlock pull up (14B). Always apply both brakes.

14B

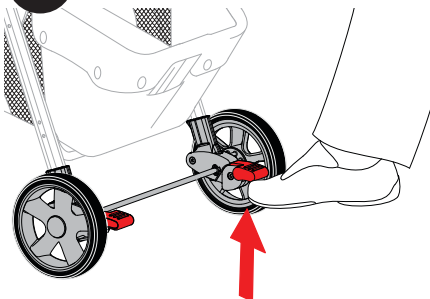

How to Attach Chicco Infant Car Seat

⚠️WARNING

ONLY use this product with a Chicco infant car seat. Use of this product with other manufacturer's infant car seats may result in injury or death. Only use this product to transport infants that are within the size and weight limitations of the infant car seat. Refer to your Chicco infant car seat owner's manual for additional warnings and use instructions before using this product. Always secure your child with the harness when using the infant car seat with this product.

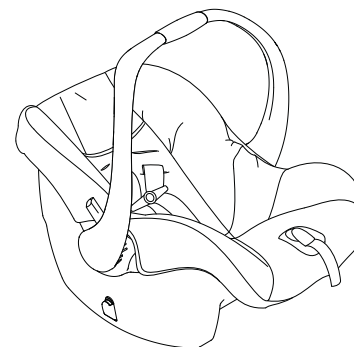

How to Attach Chicco Infant Car Seat

15A

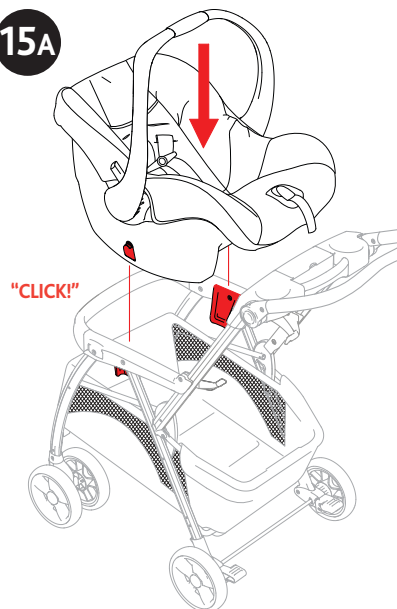

15. Place the Chicco infant car seat into the caddy frame (15A). The infant car seat will click into the attachment points (15B).

Note: Pull up on the infant car seat to make sure it is securely attached to the Caddy frame (15C).

15B

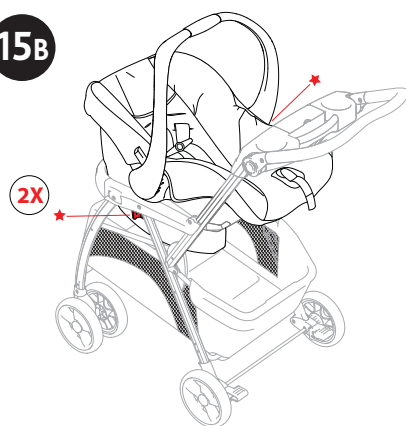

15c

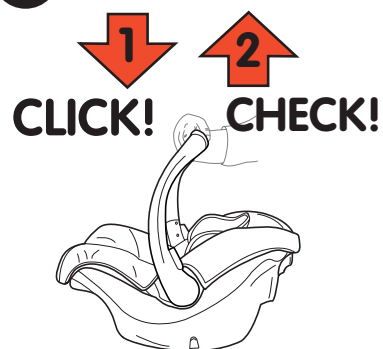

How to Remove Chicco Infant Car Seat

16

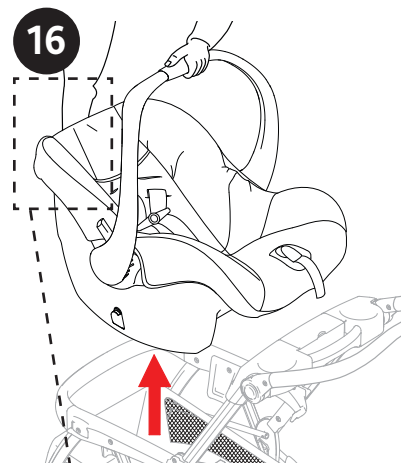

16. To remove the infant car seat, squeeze the Release Handle on the back of the infant car seat and lift up on the carrying handle.

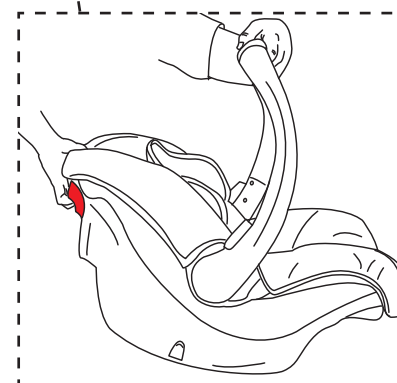

How to Fold Caddy

⚠ WARNING

When folding the caddy, make sure that your child and other children are at a safe distance. Ensure that during the operations, the movable parts of the caddy do not come in contact with your child.

17A

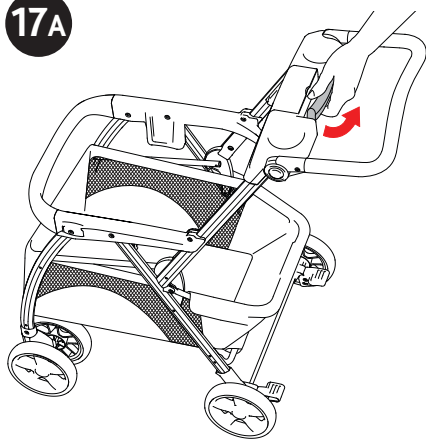

17A. To fold Caddy: Make sure to remove the infant car seat. Lift the Release Handle on the parent tray.

How to Fold Caddy

17B

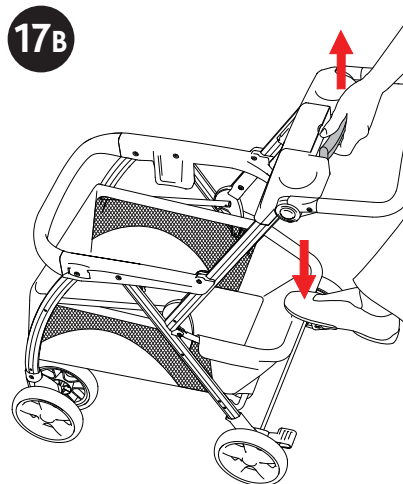

17B. While pulling up on the Release Handle, push down on the Storage Basket with your foot. The Caddy will automatically fold, latch and stand on its own. To make the Caddy more compact, fold the Caddy Handle by pushing in on both buttons (as shown) and rotating the Caddy Handle down into the storage position (17C).

17C

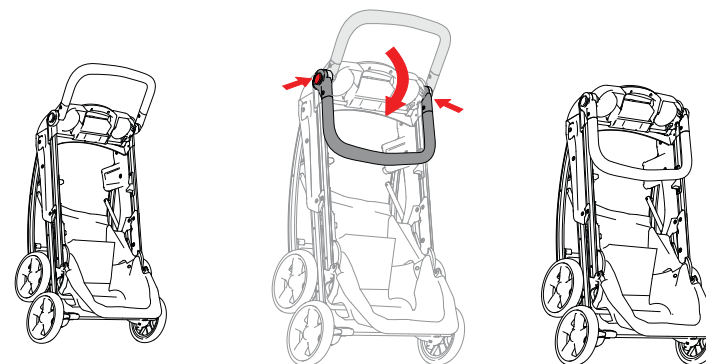

Cleaning and Maintenance

This product requires regular maintenance. The cleaning and maintenance of the caddy must only be carried out by an adult.

CLEANING

Please refer to the care label for instructions on cleaning the fabric parts of the caddy.

Periodically wipe clean plastic parts with a soft damp cloth. Always dry the metal parts to prevent the formation of rust if the caddy has come into contact with water.

MAINTENANCE

Lubricate the moving parts only if necessary, with a light application of a silicone based lubricant. If wheel squeaks, use a light oil (e.g., WD-40, 3-in-1, or sewing machine oil). It is important to get the oil in the axle and wheel assembly as illustrated. Periodically check the caddy for loose screws, worn parts, torn material or stitching. Replace or repair the parts as needed. Use only Chicco replacement parts. To avoid friction that may prevent the correct operation of the caddy, ensure that all the movable plastic parts placed along the metal frame are clean of dust, dirt or sand. Keep the caddy in a dry place. If caddy becomes wet open and allow caddy to dry completely. Prolonged exposure to direct sunlight may cause the fabric to fade and plastic parts to warp.

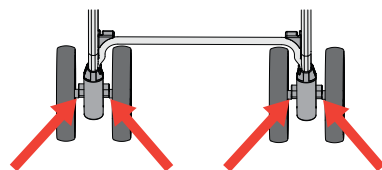

For More Information

For USA customers :

If you have any questions or comments about this product, or are missing any of the parts. Please do not return this product to the store. Contact us in one of the following ways:



(877)-424-4226



info.usa@artsana.com



www.chiccousa.com



1826 William Penn Way
Lancaster, PA 17601



www.chiccousa.com